

30CLS



FEATURES & BENEFITS

- Robust and high quality bronze body with integral seating surfaces
- Offers the ultimate in dependable service wherever minimum pressure drop is important
- WRAS Approved for use with potable water
- Inside screw pattern with non-rising stem



MATERIALS

Part	Material	Specification
Body	Bronze	BS EN 1982 (CC491K)
Bonnet	Bronze	BS EN 1982 (CC491K)
Stem	DZR Brass	BS EN 12164 CW602N
Disc	Bronze	BS EN 1982 (CC491K)
Stem Retainer	DZR Brass	BS EN 12164 CW602N
Packing Ring	Asbestos Free	
Gland (28-54 only)	Brass	BS EN 12164 CW614N
Lockshield	Brass	BS EN 12164 CW614N
Compression Olive	Brass	BS EN 12449:1999 CW505L OR CW507L
Compression Nut	Brass	BS EN 12165 CW617N

DIMENSIONS AND WEIGHTS

SIZE	A (mm)	B (mm)	D (mm)	WEIGHT (kg)
15mm	69	78	26.5	0.34
22mm	75	90	23.5	0.50
28mm	86	110	25.5	0.70
35mm	100	115	30.5	0.95
42mm	111	136	34.5	1.45
54mm	133	160	37	2.50

DIMENSIONAL DRAWING

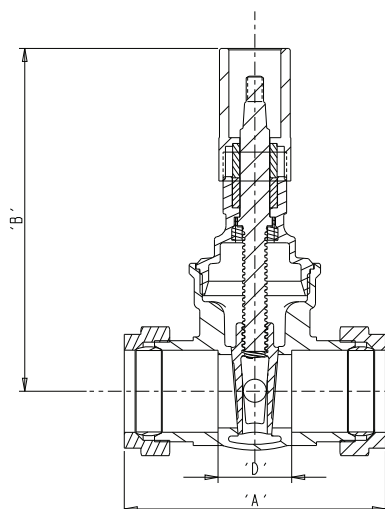

PRESSURE/TEMPERATURE RATINGS COMPRESSION

PRESSURE (bar)	16.0	14.3	12.6	10.0	8.7	7.8	6.9	6.0	5.0
TEMPERATURE °C	-10 to 30	40	50	65	80	90	100	110	120

Intermediate pressure ratings shall be determined by interpolation

Pressure Rating: PN16 • UK End Connection: Compression ends to BS EN 1057: 2006: Half hard R250 • Operator: Handwheel.
 Gate valves are best for services that require infrequent valve operation and where the disk is kept either fully open or closed. They are not practical for throttling • Specification: Valves are manufactured in accordance with BS EN 12288: 2003 (formerly BS 5154) PN20 for Series B ratings, but are limited to the pressure/temperature ratings detailed in BS EN 1057: 2006 for compression end fittings.
 This valve is to be used on Group 2 liquids only, as defined by the Pressure Equipment Directive 97/23/EC.



PO BOX 719, IPSWICH, IP1 9UD
 HOME SALES: +44 (0)1744 458670
 EXPORT SALES: +44 (0)1744 458671
 TECHNICAL HELPLINE: 0845 604 1790

FAX: +44 (0)1744 26912
 EMAIL: uksales@hattersley.com
 EMAIL: export@hattersley.com
www.hattersley.com

Every effort has been made to ensure that the information contained in this publication is accurate at the time of publishing. Crane Ltd assumes no responsibility or liability for typographical errors or omissions or for any misinterpretation of the information within the publication and reserves the right to change without notice.

H_30CLS_06_2010